

RETAIL / OFFICE LAND FOR SALE

Weber Road at Grand Haven Circle in Romeoville, Illinois



Two outstanding pads ready for development.

Lot 2: 1.5 improved acres zoned, entitled and municipally approved for a branch bank or QSR with drive up. Adjacent to new Walgreen's and 15,000 s.f. shopping Center.

Lot 4: 2.1 acres mass graded with utilities to the property line and off-site detention provided. Perfect for medical or other professional office use.

Traffic Counts

23,900 VPD along Weber Rd.

Demographics

2008 Est. Ave. Income
2008 Est. Households
2008 Est. Population

1 mile

\$57,267
553
2,113

3 miles

\$72,440
13,851
40,955

5 miles

\$66,127
59,381
166,218

PREFERRED
Development

Joe Padorr 312.327.2700 x229

www.preferreddevelopment.com

Site Plan

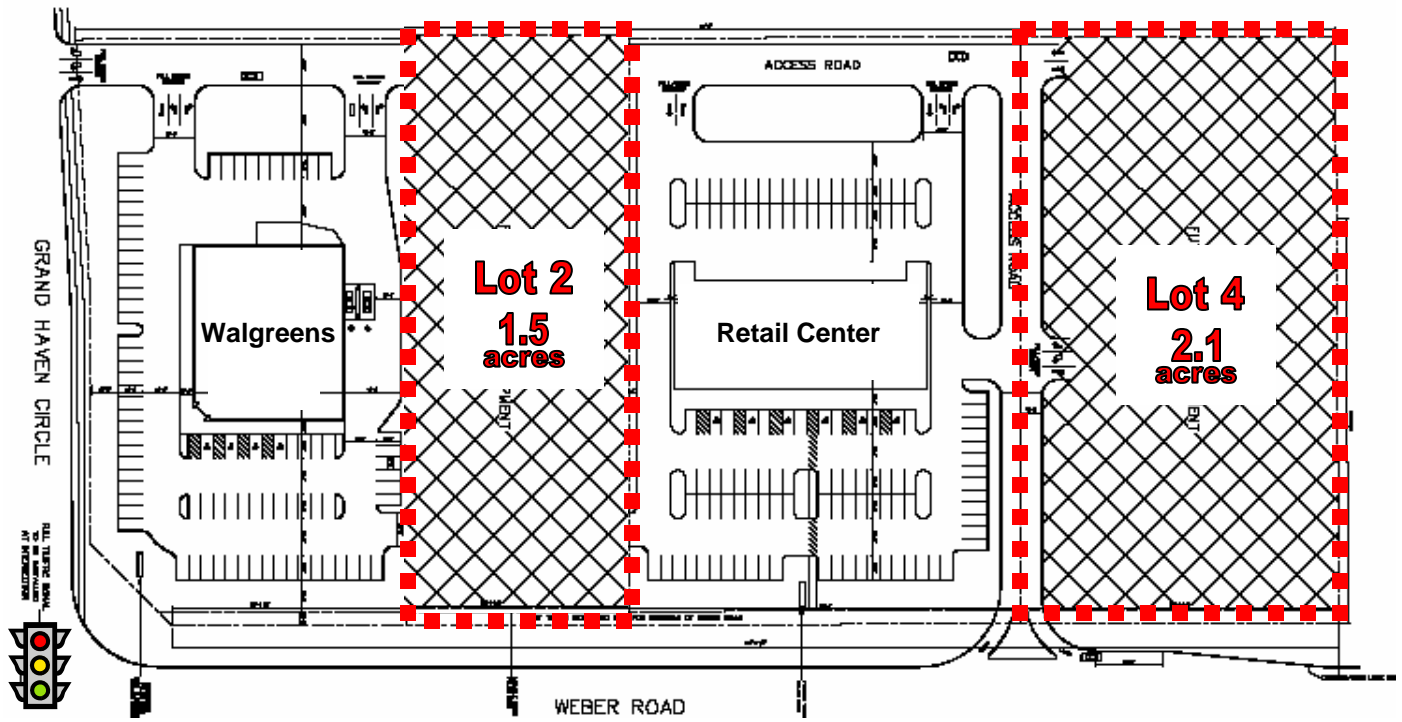

Adjacent Walgreens



Adjacent retail center

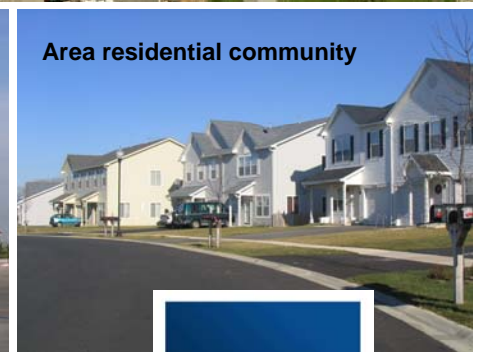

Area residential community

Joe Padorr, Preferred Development: 312.327.2700 x 229
joe@preferreddevelopment.com

